



Click the Below Categories to See Our
Full Stock Range:

Welded Pipes to ASTM A358 Class 1
Grades 304L & 316L

Welded Pipes to ASTM A312
Grades 304L & 316L

Seamless Pipes to ASTM A312 Grades
304L & 316L

End Caps to ASTM A403
Grades 304L & 316L



Stock Range For:
Welded Pipe - ASTM A358 Class 1
Grades 304L & 316L

Nom Pipe Size	O.D. mm	Sch 10s	Std Sch 40s	XS Sch 80s	Full Sch 80	Sch 100	Sch 120	Sch 160
8"	219.08	3.76 20.25	8.18 43.16	12.70 65.59				
10"	273.05	4.19 28.20	9.27 61.20	12.70 97.46	15.09 97.40		21.44 133.06	28.58 208.14
12"	323.85	4.57 36.53	9.53 74.92	12.70 97.46	17.48 133.98	21.44 159.91		
14"	355.60	4.78 41.92	9.53 81.33	12.70 107.39	19.05 160.44			
16"	406.40	4.78 47.99	9.53 93.27	12.70 123.30	21.44 206.52			
18"	457.20	4.78 54.06	9.53 105.16	12.70 139.15				
20"	508.00	5.53 69.62	9.53 117.15	12.70 155.12				
22"	558.80	5.53 76.66						
24"	609.60	6.35 95.86	9.53 141.12	12.70 187.06				
30"	762.00	7.92 153.85						

Black = Wall Thickness in Millimetres

Red = Weight Per Metre in Kilograms

Although every effort has been made to give accurate information, PipeXtra Stainless Ltd accept no responsibility for any errors.

Items only available in 316L Bordered in Blue

PipeXtra Stainless Ltd, Unit 2B Red Rose Court, Sunnyhurst Road, Blackburn,
Lancashire, Uk, BB2 1PS – Tel: 01254 672999 Email: sales@stainlesscutpipe.co.uk



Stock Range For: Welded Pipe ASTM A312 Grades 304L & 316L

Black = Wall Thickness in Millimetres
Red = Weight Per Metre in Kilograms

Although every effort has been made to give accurate information, PipeXtra Stainless Ltd accept no responsibility for any errors.

**PipeXtra Stainless Ltd,
Unit 2B Red Rose Court,
Sunnyhurst Road,
Blackburn,
Lancashire, UK,
BB2 1PS
Tel: 01254 672999**

Email: sales@stainlesscutpipe.co.uk

Nom Pipe Size	O.D. mm	Sch 10s	Full Sch 10	Sch 20	Std Sch 40s
½"	21.34	2.11 1.01			2.77 1.29
¾"	26.67	2.11 1.30			2.87 1.71
1"	33.40	2.77 2.12			3.38 2.54
1 ¼"	42.16	2.77 2.73			3.56 3.43
1 ½"	48.26	2.77 3.15			3.68 4.11
2"	60.33	2.77 3.98			3.91 5.52
2 ½"	73.03	3.05 5.34			5.16 8.76
3"	88.90	3.05 6.54			5.49 11.45
3 ½"	101.60	3.05 7.52			5.74 13.77
4"	114.30	3.05 8.48			6.02 16.31
5"	141.30	3.40 11.74			6.55 22.10
6"	168.28	3.40 14.04			7.11 28.68
8"	219.08	3.76 20.25		6.35 33.31	8.18 43.16
10"	273.05	4.19 28.20		6.35 41.77	9.27 61.20
12"	323.85	4.57 36.53		6.35 49.73	9.53 74.92
14"	355.60	4.78 41.92	6.35 55.56		
16"	406.40	4.78 47.99	6.35 63.57		
18"	457.20	4.78 54.06			
20"	508.00	5.53 69.62			
24"	609.60	6.35 95.86			



Stock Range
For:
Seamless Pipe
ASTM A312
Grades
304L & 316L

Black = Wall Thickness in Millimetres
Red = Weight Per Metre in Kilograms

Although every effort has been made to give accurate information, PipeXtra Stainless Ltd accept no responsibility for any errors.

PipeXtra Stainless Ltd,
Unit 2B Red Rose Court,
Sunnyhurst Road,
Blackburn,
Lancashire, UK,
BB2 1PS
Tel: 01254 672999
Email:
sales@stainlesscutpipe.co.uk

Nom Pipe Size	O.D. mm	Sch 10s	Std Sch 40s	XS Sch 80s	Sch 120	Sch 160	Sch XXS
1/8"	10.29		1.73 0.37	2.41 0.48			
1/4"	13.72	1.65 0.48	2.24 0.64	3.02 0.81			
3/8"	17.15	1.65 0.64	2.31 0.86	3.20 1.12			
1/2"	21.34	2.11 1.01	2.77 1.29	3.73 1.64		4.76 1.98	7.47 2.65
3/4"	26.67	2.11 1.30	2.87 1.71	3.91 2.23		5.56 2.94	7.82 3.69
1"	33.40	2.77 2.12	3.38 2.54	4.55 3.28		6.35 4.30	9.09 5.75
1 1/4"	42.16	2.77 2.73	3.56 3.43	4.85 4.53		6.35 5.69	9.70 7.88
1 1/2"	48.26	2.77 3.15	3.68 4.11	5.08 5.49		7.14 7.34	10.16 9.69
2"	60.33	2.77 3.98	3.91 5.52	5.54 7.59		8.74 11.28	11.07 13.65
2 1/2"	73.03	3.05 5.34	5.16 8.76	7.01 11.58		9.53 15.14	14.02 20.70
3"	88.90	3.05 6.54	5.49 11.45	7.62 15.50		11.13 21.65	15.24 28.09
3 1/2"	101.60	3.05 7.52	5.74 13.77	8.08 18.90			
4"	114.30	3.05 8.48	6.02 16.31	8.56 22.65	11.13 28.32	13.49 34.02	17.12 41.63
5"	141.30	3.40 11.74	6.55 22.10	9.52 31.41		15.88 49.83	
6"	168.28	3.40 14.04	7.11 28.68	10.97 43.19	14.27 54.20	18.26 68.56	21.95 80.36
8"	219.08	3.76 20.25	8.18 43.16	12.70 65.59	18.26 90.44	23.01 112.90	
10"	273.05	4.19 28.20	9.27 61.20	12.70 81.55		28.58 174.82	
12"	323.85	4.57 36.53	9.53 74.92	12.70 97.46			



Stock Range For:
Western European
End Caps ASTM A403
Grades 304L & 316L

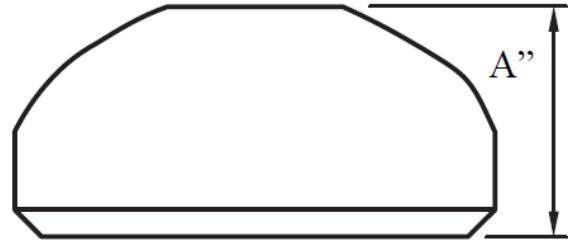

Nom Pipe Size	O.D. mm	A (")	Sch 10s	STD Sch 40s	XS Sch 80s
8"	219.08	4.00	3.76 2.47	8.18 5.40	12.70 7.80
10"	273.05	5.00	4.19 4.51	9.27 10.00	12.70 13.10
12"	323.85	6.00	4.57 6.67	9.53 13.90	12.70 17.30
14"	355.60	6.50	4.78 8.17	9.53 16.00	12.70 27.00
16"	406.40	7.00	4.78 10.67	9.53 21.00	12.70 31.50
18"	457.20	8.00	4.78 13.00	9.53 26.00	12.70 36.00
20"	508.00	9.00	5.53 17.00	9.53 34.00	12.70 42.00
24"	609.60	10.50	6.35 26.00	9.53 52.00	12.70 60.00

Black = Wall Thickness in Millimetres

Red = Weight Per Each in Kilograms

Although every effort has been made to give accurate information, PipeXtra Stainless Ltd accept no responsibility for any errors.

PipeXtra Stainless Ltd, Unit 2B Red Rose Court, Sunnyhurst Road, Blackburn,
Lancashire, Uk, BB2 1PS – Tel: 01254 672999 Email: sales@stainlesscutpipe.co.uk